



Eco



A modular lining system that doesn't cost the earth





Eco⁶ is an **extremely robust, hard-wearing and fire-resistant** 6mm gypsum panel. Its outstanding technical performance and eco credentials make Eco⁶ a product that is suitable for both new build and refurbishment projects in the modular industry.

Eco⁶ Modular

Eco⁶ has been developed in the UK by Excel and Siniat as a superior and sustainable replacement for plywood in modular buildings. The innovative panels have a high-density glass fibre reinforced core, tough paper liners, and a range of decorative, washable finishes to choose from.

As well as being a high-performance lining product for new builds, the lightweight Eco⁶ is also ideal for modular refurbishments to overclad existing linings whilst improving the fire, sound and thermal performance of a unit.



Safe | Sound-resistant | Sustainable



Fire Rated

- BS 476 pt 7 Class 1
- BS 476 pt 6 Class O
- Euroclass A2

Excel can provide fire assessments based on specific design detail on application

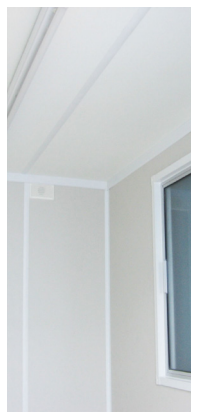
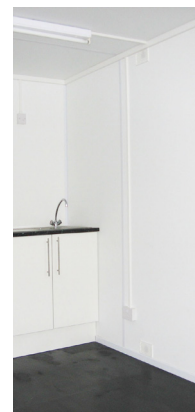

What is Gypsum?

Although gypsum is a naturally occurring mineral, Eco⁶ uses the gypsum generated as a harmless by-product of many industrial processes or from power station waste. This innovative waste product utilisation means that Eco⁶ can claim to be manufactured from 98% recycled materials.



The Benefits of Eco⁶

Excel and Siniat have developed the Eco⁶ product with a unique range of features and advantages:

- Manufactured in the UK
- Stable price - unaffected by currency fluctuation
- Consistently available
- Fire rated to British & European Standards
- No harmful substances
- Non-toxic
- BES6001 Responsible Sourcing Category - Very Good
- Low carbon release
- No VOC Emissions
- Recycled Content & Recyclable
- Good sound attenuation
- Can be cut with a knife (score & snap)
- Sustainable
- REACH classified non-hazardous

Bonded Thermal Upgrade

Eco⁶ can be bonded to various insulation materials for greater thermal efficiency.

Eco⁶ bonded with 50mm PIR insulation and applied over existing 80mm earth-wool can create a wall or ceiling capable of achieving a U-value as low as 0.23 W/m²K.

Bonded Thermal Upgrade

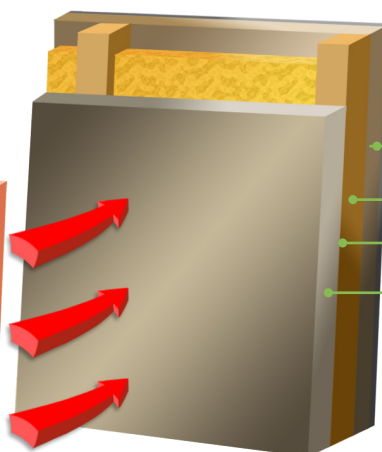
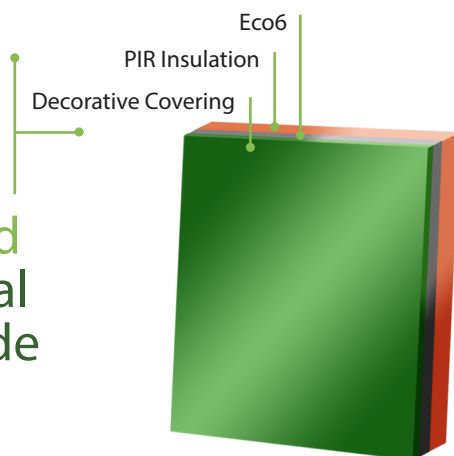

Standard Wall Construction

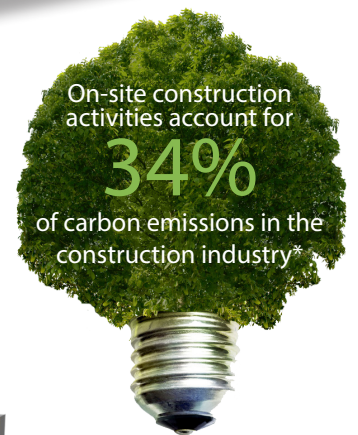

*Temporary Site Accommodation Guidance. Carbon Trust 2010

Eco⁶ Trio-plex

Eco⁶ Trio-plex provides triple protection with the addition of an optional metallised polyester film on the reverse offering: total vapour control with impressive reflective thermal insulation, plus the hard wearing decorative surface.

3x
protection

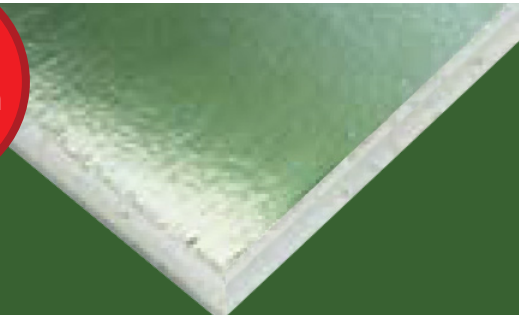



Garic specify Eco⁶ because, as a market leader, we have a responsibility to our customers to procure responsibly sourced key materials wherever we can. Eco⁶ enables us to eliminate tropical hardwood plywood from our unit linings whilst also providing many additional benefits to our customers, such as greater fire resistance, noise attenuation & thermal efficiency.

Eco⁶ is made in the UK and helps us to deliver on our commitment to reduce the carbon footprint of our site accommodation; we would not hesitate to recommend it.

Steve Ogden
Production Manager Garic



The product is easy to handle and fit in large quantities in our factory and is a preferred choice of many of our customers since we introduced the product as an option as it is strong and durable with good thermal and fire resistant properties when compared to other products.



Ian Ashworth
Product Manager Stackright



The Eco⁶ product has been a great addition to the specification of our fleet at Mobile Mini. Eco⁶ offers excellent thermal performance without the weight and density of the traditional 12mm plasterboard used in most eco situations. This makes our accommodation units warmer, lighter and easier to maintain.

Dave McIntosh
Product & Technical Advisor Mobile Mini





working in partnership with



Usage:

Usually board can be cut to size using a knife (score and snap) avoiding the use of power tools and associated dust.

Eco⁶ can be fixed with staples or bonded to studwork.

As Eco⁶ is very strong and lightweight, one person can handle it comfortably.

Sheet sizes

Currently available ex stock in 2135 x 1220, 2440 x 1220 and 3050 x 1220, packed in 100 sheets per pallet (other sizes are available on request).

Compliance Authority

The board complies with BS EN 520:2004 -Type A

Physical properties

Strength - BS EN 520 Breaking load longitudinal >300 N, transverse > 150 N

Surface spread of flame - Class 1 to BS 476 pt 7

Fire propagation index - $1 < i < 3$ to BS 476 pt 6 Class O

Limited combustibility

Euroclass A2 to EN 13501 - 2

Moisture content < 2 %

Sound insulation - Rw single sheet 18 dB

Mass - 6 kg/ m²

Thermal conductivity - 0.23 W/mK

Thermal resistance R - 0.025 m² K/W

Joist and stud centres - maximum is 600 mm.

Handling and fixing

The handling and fixing, cutting and screwing instructions are the same as those for 9.5 mm GTEC standard Board (details on application).



Resource friendly



Robust



Fire-Rated



Recycled & recyclable



One man fixing



Score & snap



Low Carbon footprint



Lightweight

About Excel & Siniat

Excel is an independent family-run business and we take great pride in providing an unrivalled level of commitment to our customers. We continuously invest in our people, our plant and our products to ensure that our customers receive the highest quality of service.

Our partnership with Siniat has led to the development of Eco⁶ with its outstanding technical performance. Siniat form part of the global Etex group, manufacturing drywall products for partitions, ceilings, wall linings and external sheathing purposes.

By forming key partnerships we are able to consistently deliver high-performance solutions.

Jeff Thomas
Managing Director



A modular lining system that doesn't cost the earth



Excel Laminating Limited

Unit 3, Kingston International Business Park, Hedon Road, HULL HU9 5NX

T. (01482) 326866 F. (01482) 326855 E. sales@excel-laminating.co.uk



www.excel-laminating.co.uk